

THE **PUSH** INJECTOR

REVOLUTIONARY DESIGN

2 IN 1 use as a feed tube injector or bottle mount injector

- GREATLY reduced hand strain
- ERGONOMIC hand/arm push injection action
- FAST injection refill time
- BALANCE with mid mounted bottle attachment
- STRENGTH reliability and durability

The PUSH Injector is designed for injectable products only. Do not use it for any other application other than injecting. The manufacturer will not take responsibility for incorrect use of the injector.

INSTRUCTIONS FOR USE

- 1 Remove injector from packaging.
- 2 USE WITH FEED TUBE: Attach the feed tube (not shown) to the inlet fitting (item 1) then attach to the vaccine pack using the bottle connection cap.
- 3 USE WITH BOTTLE ATTACHMENT: Fit the bottle attachment fitting to the injector making sure it fits correctly over the hanging hook (item 5). Connect the curved feed tube (item 2) to the inlet fitting (item 1). Fit the vaccine pack into the locking neck of the bottle attachment by first turning the locking ring (item 4) in a clockwise direction until the locking tabs are open. Place the pre-pierced bottle onto the centre needle (item 3) and push down fully. Now secure by turning the locking ring (item 4) anticlockwise.
- 4 Attach the needle to the injector. DO

NOT remove the nut. Place the needle hub into the needle mount (item 6) and turn clockwise to tighten. Turn anticlockwise to remove the needle.

5 Set the dose to the maximum setting and prime the injector by squeezing the handle and lever (items 7 & 8). Prime to ensure all air is removed from the cylinder.

6 When the injector is primed, set the dose in the dose window to your required setting.

CARE AND MAINTENANCE

1 Remove the vaccine pack from the injector.

2 Place the feed tube into clean water and pump through to clean.

3 Re-lubricate the cylinder with NJ Phillips Lubricant before storing. Remove the cylinder by turning it anticlockwise until the cylinder lugs align with the handle grooves, then pull straight backwards.

STERILIZATION

1 Connect the handpiece to the feed tube, fit the needle and lock tightly.

2 Pump the handpiece until it is filled with water and then suspend the handpiece and the feed tube in a container of water, then bring to the boil.

3 Boil the equipment for 10 to 20 minutes.

4 Remove the instrument from the container, wrap a cloth around the handle and pump dry.

NOTE: It is neither necessary, nor desirable, to dismantle the handle, or any other component, before sterilizing.

1. Inlet Fitting
2. Feed Tube
3. Needle
4. Bottle Locking Ring
5. Hanging Hook
6. Needle Mount
7. Handle
8. Lever

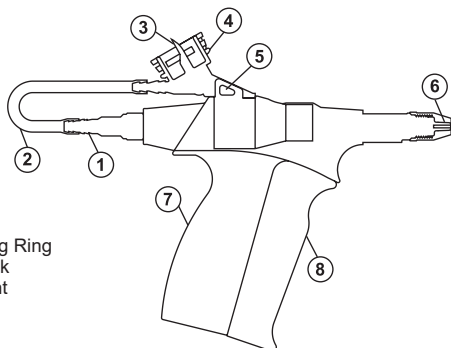

Assembled at an ISO 9001:2015 accredited facility

Contact your local NJ Phillips product representative for service kit details

Email: ahdsinfo@datamars.com

Website: njphillips.com

Toll free number (Australia): 1800 247 175

njphillips.
DATAMARS

355 0000-818